

Ö1 Plus

Car Seat - R129

Rearward Facing: Child height 40cm-87cm/ Child weight ≤ 13 kg;



IMPORTANT - READ THE INSTRUCTIONS CAREFULLY BEFORE USE AND KEEP FOR FUTURE REFERENCE

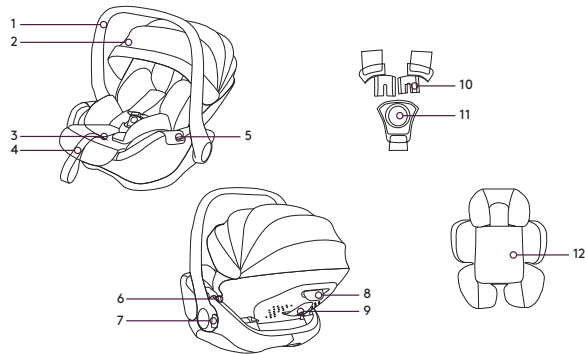

- 1 Handle
- 2 Canopy
- 3 Webbing Adjustment Button
- 4 Adjustment Webbing
- 5 Side Guide
- 6 Stroller Fix Releasing Button

- 7 Handle Adjustment Button
- 8 Backrest Adjustment Button
- 9 Rear Guide
- 10 Harness Connector
- 11 Buckle
- 12 Insert Cushion

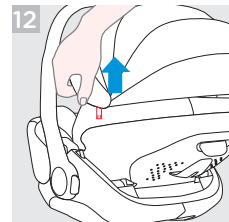
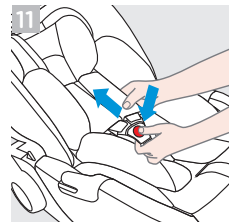
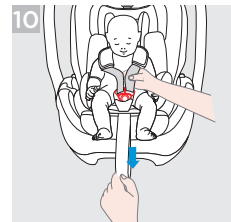
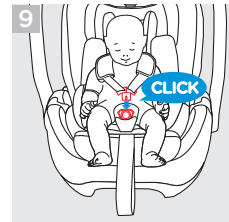
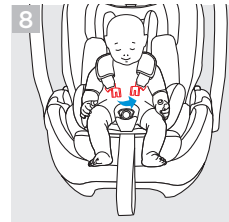
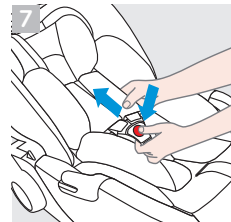
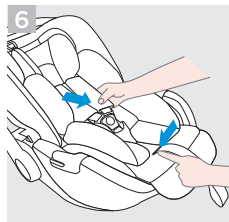
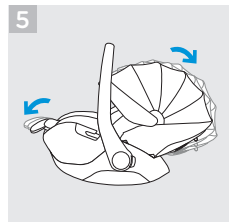
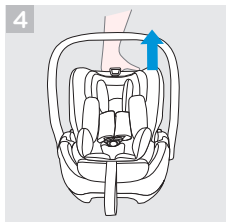
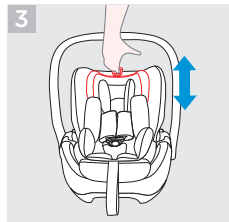

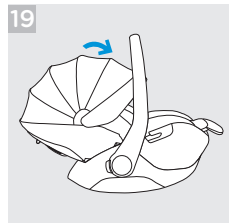
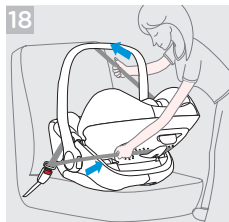
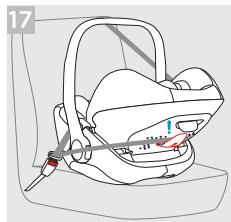
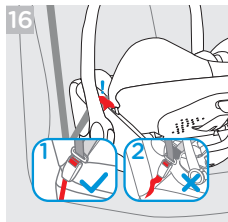
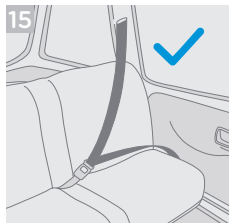
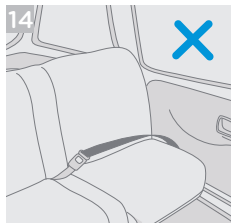

Welcome to Nado

You have purchased a high quality, fully certified enhance child safety enhanced child restraint. This product is suitable for the use of child's height and weight up to 87cm and 13kg.

Carefully read this Instruction Manual and follow the installing steps because this is the **ONLY** way to protect your child from serious injury or death in case of an accident, and to provide comfort to your child while using this product.

Keep this instruction manual for future reference.

Please confirm

To use this Nado enhanced Infant child restraint according to the UN Regulation No.129, your child must meet the following requirements.

Child height 40cm-87cm/ Child weight \leq 13kg

Please read all the instructions in this manual before installing and using the product.

! IMPORTANT: KEEP FOR FUTURE REFERENCE. PLEASE READ CAREFULLY.

Warnings

Please check before you purchase this enhanced infant child restraint to make sure it can be installed properly in your vehicle.

NO enhanced infant child restraint can guarantee full protection from injury in an accident. However, proper use of this enhanced infant child restraint will reduce the risk of serious injury or death to your child.

To use this enhanced infant child restraint according to the ECE R129/04 Regulation, your child must meet the following requirements.

01 Plus: Child height 40cm-87cm/ Child weight \leq 13kg (approximately 1.5 years old or under). Any straps holding the enhanced child restraint to the vehicle should be tight; any support-leg should be in contact with the vehicle floor; any straps or impact shields restraining the child should be adjusted to the child's body, and that straps should not be twisted. **DO NOT** install this enhanced infant child restraint without following the instructions in this manual or

you may put your child at serious risk of injury or death. **NEVER** leave your child unattended with this enhanced infant child restraint.

DO NOT make any modification to this enhanced infant child restraint or use it along with component parts from other manufacturers.

DO NOT use this enhanced infant child restraint if it has damaged or missing parts.

DO NOT have your child in large/oversized clothes because this may prevent your child from being properly and securely fastened by the shoulder harness straps and the crotch strap between the legs.

DO NOT use this enhanced infant child restraint without the soft goods.

The soft goods should not be replaced with any besides the ones recommended by the manufacturer. The soft goods constitute an integral part of the enhanced infant child restraint performance.

DO NOT put anything other than the recommended inner

cushions in this enhanced infant child restraint. Be sure that the enhanced infant child restraint is installed in such a way that no part of it interferes with movable seats or in the operation of vehicle doors. DO NOT continue to use this enhanced infant child restraint after it has suffered any type of crash, even a minor one. Replace immediately as there may be invisible, structural damage from the crash. Remove this infant carrier module and base from the vehicle seat when it is not in regular use. Consult the distributor for issues concerning maintenance, repair and part replacement. To avoid the risk of falling out, always secure the child using the child harness when the child is placed in infant carrier module, even when the enhanced infant child restraint is not in the vehicle. Before carrying the infant carrier module by hand, ensure that the child is fastened with the child harness, and that the handle is correctly locked in a vertical

position. To avoid serious injury or death, NEVER place infant carrier module on elevated surface seat with child in it. The parts of this enhanced infant child restraint should not be lubricated in any way. Always secure child in enhanced infant child restraint, even on short trips, as this is when most accidents occur. DO NOT leave this enhanced infant child restraint or other items unbelted or unsecured in your vehicle because an unsecured enhanced infant child restraint can be thrown around and may injure occupants in a sharp turn, sudden stop, or collision. DO NOT place a rear-facing enhanced infant child restraint on front seat with activated front airbag. Death or serious injury may occur. Please reference vehicle owner's manual for more information.

DO NOT place any objects in the Support leg area in front of your base. DO NOT use any load bearing contact points other than those described in the instructions and marked on the enhanced infant child restraint. Please do not use this enhanced child restraint if the enhanced child restraint has dropped from a significant height, hit the ground at a considerable speed, or has visible signs of damage. We are not responsible to replace if the car seat has been damaged under these abnormal conditions. A new car seat will need to be purchased when any of the aforementioned conditions occurs.

Emergency

In case of emergency or accidents, it is most important to have your child taken care of with first aid and medical treatment immediately.

Product Information

With vehicle belt

1. This is Universal Belted Enhanced Child Restraint System. It is approved according to UN Regulation NO 129. for use primarily in "Universal seating positions" as indicated by vehicle manufacturers in the vehicle user's manual.

2. If in doubt, consult either the Enhanced Child Restraint System manufacturer or the retailer.

Materials Plastics, metal, fabrics

Choose Your Installation

Figure for Installation	Suitable for
	<p>Child height 40cm-87cm Child weight ≤13kg Child age ≤18 months</p>

01 Plus is compatible with Lotus Base. For the use with Lotus Base, please refer to the individual base's manual.

Installation Concerns

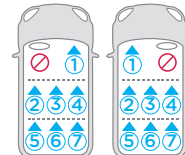
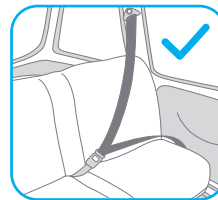
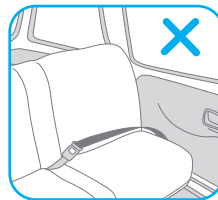
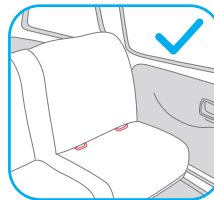

DO NOT install this enhanced infant child restraint on vehicle seats that face sideways or rearward with respect to the moving direction of the vehicle.

DO NOT place rear-facing enhanced infant child restraint on front seat with air bag, because death or serious injury may occur. Please reference vehicle owner's manual for more information.

It is recommended to install this enhanced infant child restraint on the rear vehicle seat.

DO NOT install this enhanced infant child restraint on vehicle seats movable during installation.

Handle Adjustment

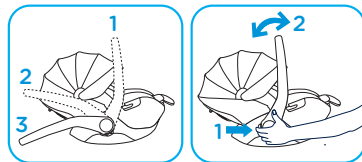

The handle of the infant carrier module can be adjusted to 3 positions.
Position for car, hand or stroller transportation.
To adjust the handle, squeeze the handle buttons on both sides to release it, and then rotate the handle until it clicks into any of the 3 positions.

Height Adjustment

for Head Support and Shoulder Harnesses

see images (1) - (3)

Check that Shoulder Harness Straps are set at the proper height. Please choose the proper pair of shoulder harness slots according to the child's height.

The bottom of headrest must be level with the highest point of child's shoulder, it is shown as (1), but not above the shoulder line.(2)

If the Shoulder Harness Straps are not at proper height, the child might be ejected from the enhanced infant child restraint if there is a crash.

Pull the head support adjustment loop, meanwhile pull up or push down the head support until it snaps into one of the 6 positions. The head support positions are shown as (3)

Backrest Adjustment

see images (4) - (5)

There are 3 angles for the backrest.
Please press backrest adjustment button (4) to heighten or lower the backrest. (5)

Securing Child

in the enhanced Infant Child Restraint

see images (6) - (10)

Note

1. Insert cushion is for children's protection. Children whose height is under 60cm are suitable to use the infant insert.
2. After the child is placed in the seat, check if the shoulder harnesses are set to the correct height.



Remove the insert cushion when the infant's shoulders no longer fit comfortably.

1. While pressing the harness adjustment button, pull completely the two shoulder harnesses of the enhanced infant child restraint. (6)
2. Unlock the buckle of the harnesses by pressing the red button. (7)
3. Place child into the infant carrier module and lock the buckle. (8) & (9)
4. Tighten the shoulder harnesses by pulling adjustment webbing. (10)

Detaching Canopy and Seat Pad

see images (11) - (13)

To re-assemble the soft goods, reverse the aforementioned steps.

Installation without base

see images (14) - (19)

DO NOT install this infant carrier module on vehicle seats with Lap Belts. (14)

This infant carrier module is suitable for vehicle seats with a 3-point Retractor Safety Belt only. (15)

1. Place the infant carrier module onto the vehicle seat where you wish to put it. Pull the vehicle safety belt out and lock it into the vehicle buckle, sliding the vehicle lap belt into the side guides of the infant carrier module. (16)
- The infant carrier module can not be used if the vehicle afety belt buckle (female buckle end) is too long to anchor

the infant carrier module securely. (16-2)

2. Slide diagonal belt into the rear guide. (17)

3. Pull the vehicle shoulder belt to fasten the infant carrier module tightly and securely. (18)

Tension the vehicle safety belt as much as possible, checking that it is not loose or twisted.

After installing the infant carrier module, always check that the vehicle belts are routed correctly and securely fastened into the vehicle buckle.

5. The hood can be opened completely to protect your child from the sun uttermostly, just pull the hood toward front. (19)

Detaching Canopy and Seat Pad

see images (22) - (24)

To re-assemble the soft goods, reverse the aforementioned steps.

Installation without base

see images (25) - (30)

DO NOT install this infant carrier module on vehicle seats with Lap Belts. (25)

This infant carrier module is suitable for vehicle seats with a 3-point Retractor Safety Belt only. (26)

1. Place the infant carrier module onto the vehicle seat where you wish to put it. Pull the vehicle safety belt out and lock it into the vehicle buckle, sliding the vehicle lap belt into the side guides of the infant carrier module. (27)
- The infant carrier module can not be used if the vehicle afety belt buckle (female buckle end) is too long to anchor



nado GmbH
Langgasse 15
95326 Kulmbach Germany
www.babynado.de